

## Vittoria Slicers Volano 350



### Overview

100% Italian made slicers from Marra Forni combine precision slicing with the classic visual appeal of a hand operated flywheel. Slicers are cast in aluminum and steel to facilitate fast and easy cleanup.

This unit is fully operated by hand, leaving you free to display your slicer anywhere to entice customers. The blade sharpener is built-in and equipped with a protection ring which meets NSF standards. Customize your slicer with RAL colors and unique flywheel styles.

### Specifications

All Slicers: Freight Class 85  
One Year Parts, Labor Warranty

### Standard Features

Cast In Aluminum And Steel  
Hand Operated; No Electrical Requirements  
Equipped With NSF Compliant Protection Ring  
Features Built-In Blade Sharpener  
Fully Operated By Hand  
Can Be Displayed Anywhere

### Optional Functions

Cast Iron Stand  
Choice of Flywheel Styles  
Available RAL Colors  
Pedestal

### Dimensions

Weight: 144 lbs  
Crated Weight: 225 lbs  
Measures: 33"L x 27.5"W x 28"H  
Crated Measures: 48"L x 40"W x 30"H

### Pedestal Optional

Measures 18"L x 13.75"W x 25"H  
(does not include slicer)  
Cast Iron Construction  
Weight: 144 lbs  
Crated Weight: 225 lbs  
All Slicers: Freight Class 85  
One Year Parts, Labor Warranty

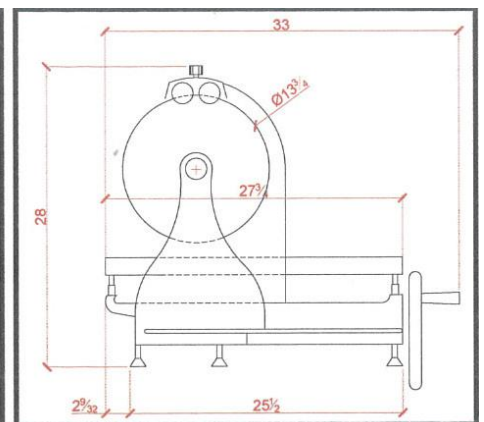
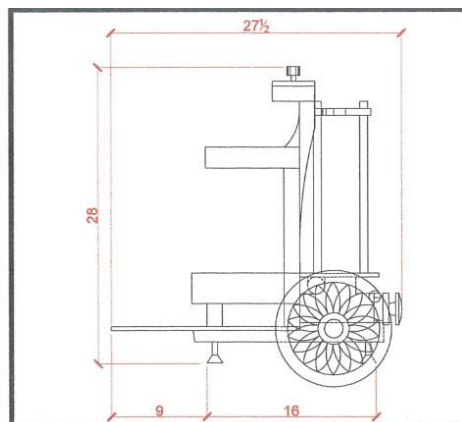
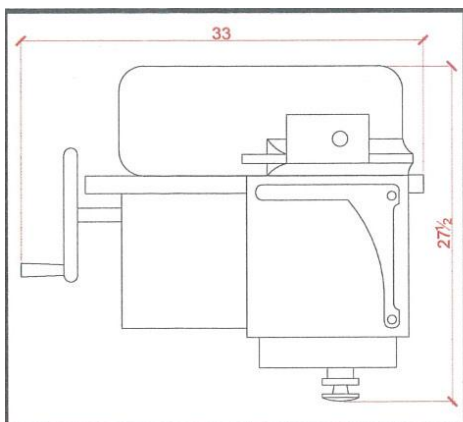

## Vittoria Slicers

Pedestal Option for Volano 300, 350, 370



### Overview

100% Italian made slicers from Marra Forni combine precision slicing with the classic visual appeal of a hand operated flywheel. Slicers are cast in aluminum and steel to facilitate fast and easy cleanup.

Our slicers are fully operated by hand, leaving you free to display anywhere to entice customers. The blade sharpener is built-in and equipped with a protection ring which meets NSF standards. Customize your slicer with RAL colors and unique flywheel styles.

### Specifications

All Slicers: Freight Class 85  
One Year Parts, Labor Warranty

### Standard Features

Cast Iron Construction  
Customize With Available RAL Colors

### Dimensions

Weight: 144 lbs  
Crated Weight: 225 lbs  
Measures: 18"L x 13.75"W x 25"H  
Crated Measures: 48"L x 40"W x 30"H

### Front View

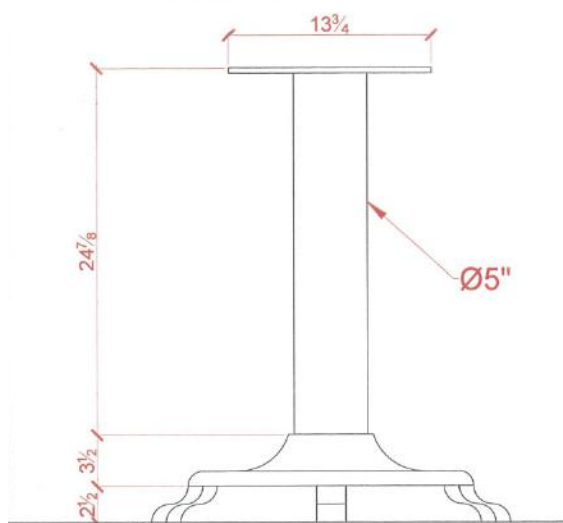

### Side View

